



HYATT
REGENCY
BELGRADE

HYATT REGENCY BELGRADE MEETINGS AND EVENTS

MEETINGS AND EVENTS AT HYATT

Hyatt Regency Belgrade

Hyatt Regency Belgrade, a luxury 5-star hotel located in New Belgrade, is just 5 minutes from Belgrade city centre, yet close to the Sava Centre and Arena – the international convention, sports, entertainment and fair venue.

Hyatt Regency Belgrade is one of Belgrade's most sophisticated event and meeting venues.

Our hotel offers venues for business meetings, conferences or weddings. Spacious, elegant and well-equipped meeting rooms, coupled with attentive and highly professional staff, have made Hyatt Regency Belgrade the leading venue in town for successful meetings, conferences, events and weddings.

Hyatt Regency Belgrade offers 8 venues:

- ◆ Crystal Ballroom – maximum 700 persons
- ◆ Beograd - maximum 80 persons
- ◆ Budva - maximum 40 persons
- ◆ Kopaonik - maximum 40 persons
- ◆ Kalemegdan - maximum 28 persons
- ◆ Boardroom - maximum 12 persons
- ◆ Focaccia - maximum 150 persons

* The foyer in front of the Crystal Ballroom may also be used as a gathering place for guests and for welcome drinks

** The Crystal Ballroom can be separated into three self-contained halls

*** Budva and Beograd venues can be connected into one venue



PHOTO GALERY

BUDVA



CRYSTAL BALLROOM



BOARDROOM



BEOGRAD



KOPAONIK



KALEMEGDAN



PHOTO GALERY

FOCACCIA



FOYER IN FRONT OF VENUES



FOYER IN FRONT OF VENUES



CAPACITY CHART



Room Name	Room Dimensions <i>L x W x H</i>	Sq. Ft. Meters	Banquet	Reception	Theater	Classroom	Boardroom	U-Shape	Hallow Square	Cabaret open end
CRYSTAL BALLROOM	97.4' x 61.6' x 16.4' 29.7m x 18.8m x 5m	6017 559	450	600	600	300	—	—	—	360
CRYSTAL A	32.1' x 61.6' x 16.4' 9.8m x 18.8m x 5m	1981 184	120	150	200	100	55	55	65	96
CRYSTAL B	33.1' x 61.6' x 16.4' 10.1m x 18.8m x 5m	2045 190	120	150	200	100	55	55	65	96
CRYSTAL C	33.1' x 61.6' x 16.4' 9.8m x 18.8m x 5m	1981 184	120	150	200	100	55	55	65	96
CRYSTAL A + B	65.3' x 61.6' x 16.4' 19.9m x 18.8m x 5m	4026 374	250	350	400	200	—	75	92	200
BALLROOM FOYER	23' x 89.5' x 14.4' 7m x 27.3m x 4.4m	2056 191	—	500	—	—	—	—	—	—
BUDVA + BEOGRAD	24.6' x 68.2' x 10.5' 7.5m x 20.8m x 3.2m	1679 156	100	150	150	90	50	45	60	80
BEOGRAD	24.6' x 40.7' x 10.5' 7.5m x 12.4m x 3.2m	1001 93	60	80	80	50	34	32	40	48
BUDVA	24.6' x 27.5' x 10.5' 7.5m x 8.4m x 3.2m	678 63	40	40	40	24	22	24	30	24
KOPAONIK	21' x 25.9' x 10.5' 6.4m x 7.9m x 3.2m	549 51	20	30	40	18	20	22	28	18
KALEMEGDAN	18.7' x 25.2' x 10.5' 5.7m x 7.7m x 3.2m	474 44	12	20	28	12	12	15	18	—
BOARDROOM	18.7' x 21.6' x 10.5'	409 39	12	—	—	—	12	—	—	—
FOCACCIA	15m x 13.5m x 3m	202	80	150	50	36	22	30	34	40
ELLINGTON'S	17m x 12m x 2.8m	204	—	150	60	—	24	—	—	32

MEETING AND EVENT VENUE FLOOR PLAN

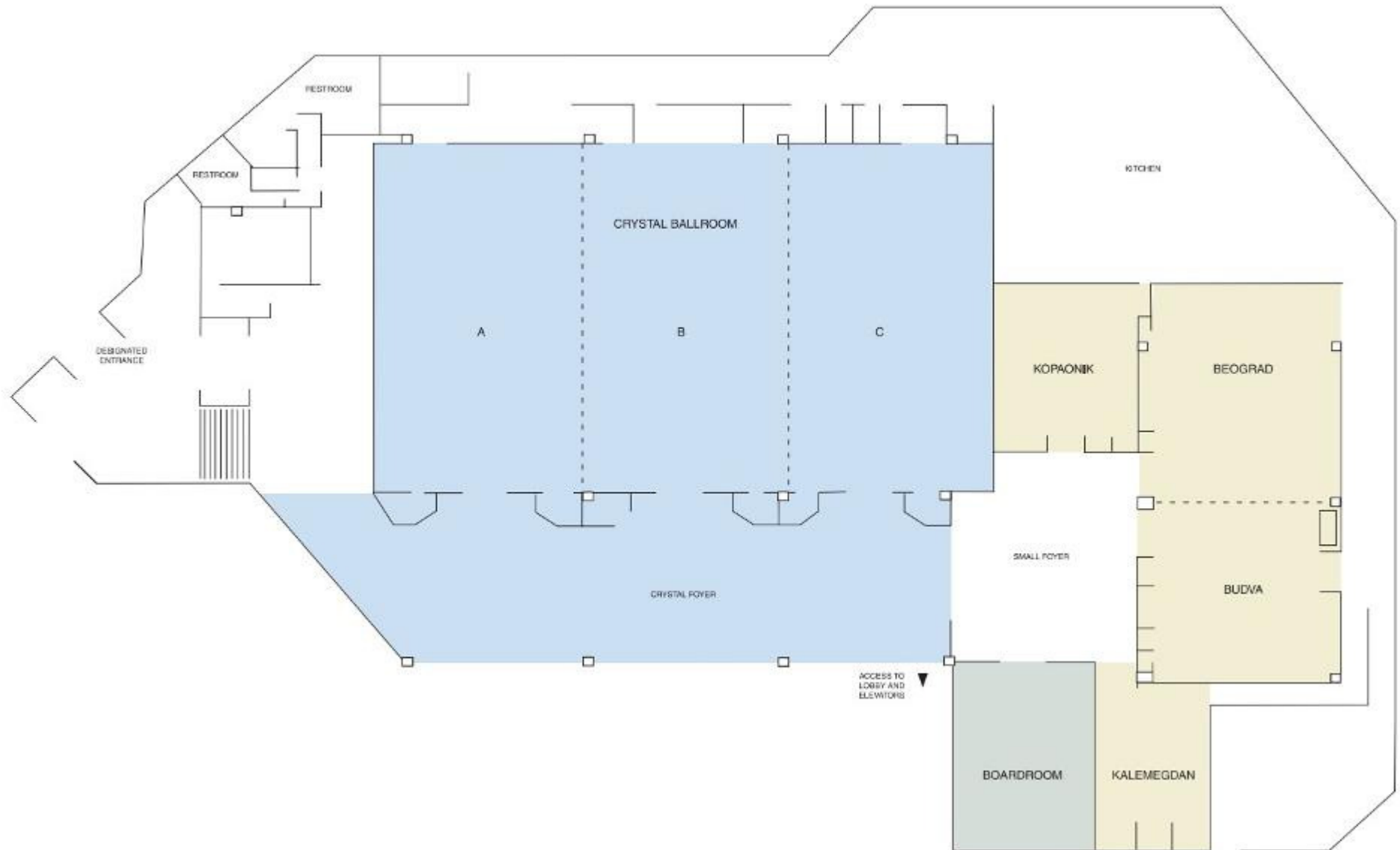

VENUE RENTAL PRICES

VENUE	Two-hours rental	Event / half day	Event / full day	With overnight hold
	EUR	EUR	EUR	EUR
Crystal (A,B,C)*	--	1,800	2,200	2,200
Crystal 2/3*	--	1,100	1,600	1,600
Crystal A*	--	600	900	900
Crystal B*	--	600	900	--
Crystal C*	--	600	900	--
Foyer	--	--	--	--
Kalemegdan**	120	240	360	--
Budva/Beograd**	300	600	870	--
Beograd**	220	440	600	--
Budva**	155	310	500	--
Kopaonik**	135	270	420	--
Boardroom**	135	270	420	--
RC Boardroom**		270	420	
Ellington's club	--	500	870	--
Focaccia***	--	600	800	--

Venue rental includes:

*Meeting set-up (water, notepad, pen), A/V equipment (sound system, 5 microphones, 1 screen, 1 LCD and technical support)

1 Internet cable line, 5 parking spots

** Meeting set up (water, notepad, pen), A/V equipment (1 flip chart, 1 screen, 1 LCD), 1 Internet cable line, 5 parking spots

*** Focaccia can be rented until 4:00pm

**** All prices mentioned in this document include 20% VAT

HYATT EXPRESS PACKAGE

Price	€ 25 (per person / per day) Minimum 15 delegates
Venue usage	One meeting room for 2 hours
Equipment	<ul style="list-style-type: none">◆ 1 Flip chart◆ 1 Screen, 1 LCD, 1 Internet cable line and Wi Fi
Conference Necessities	<ul style="list-style-type: none">◆ Mineral water◆ Notepads, Pens, Meeting stationery kit
Coffee break	Ongoing coffee break with: <ul style="list-style-type: none">◆ Filter coffee, Espresso, Tea, Water, Juices◆ Cookies

*A/V with sound system and microphone gratis for meetings above 40 participants

**Lunch buffet for minimum 15 people

All prices mentioned in this document include 20% VAT

HYATT HALF DAY PACKAGE

Price	<p>€ 32 (per person / per day)</p> <p>Minimum 15 delegates</p>
Venue usage	One meeting room up to 4 hours
Equipment	<ul style="list-style-type: none"> ◆ 1 Flip chart ◆ 1 Screen, 1 LCD, 1 Internet cable line and Wi Fi
Conference Necessities	<ul style="list-style-type: none"> ◆ Mineral water ◆ Notepads, Pens, Meeting stationery kit
Coffee break	<p>Morning or afternoon break with:</p> <ul style="list-style-type: none"> ◆ Filter coffee, Espresso, Tea, Water, Juices ◆ Cookies
Lunch	3-course set menu, lunch or international buffet for a minimum of 15 people can take place in one of Hyatt Regency Belgrade's venues. It includes mineral water, soft drinks and juices.

* A/V with sound system and microphone gratis for meetings above 40 people

**Lunch buffet for minimum 15 people

All prices mentioned in this document include 20% VAT

HYATT FULL DAY PACKAGE

Price	€ 40 (per person / per day) Minimum 15 delegates
Venue usage	One meeting room up to 8 hours
Equipment	<ul style="list-style-type: none"> ◆ 1 Flip chart ◆ 1 Screen, 1 LCD, 1 Internet cable line and Wi Fi
Conference Necessities	<ul style="list-style-type: none"> ◆ Mineral water ◆ Notepads, Pens, Meeting stationery kit
Morning Coffee break	Morning or afternoon break with: <ul style="list-style-type: none"> ◆ Filter coffee, Espresso, Tea, Water, Juices ◆ Cookies
Lunch	3-course set menu, lunch or international buffet for a minimum of 15 people can take place in one of Hyatt Regency Belgrade's venues. It includes mineral water, soft drinks and juices.
Afternoon Coffee Break	<ul style="list-style-type: none"> ◆ Filter coffee, Espresso, Tea, Water, Juices ◆ Cookies

*A/V with sound system and microphone gratis for meetings above 40 people

** Lunch buffet for minimum 15 people.

All prices mentioned in this document include 20% VAT.

HYATT MENUS

Coffee Breaks	Price per person / €
Filter coffee, espresso, tea and mineral water	2.5
Filter coffee, espresso, tea, mineral water and cookies	4
Filter coffee, espresso, tea, mineral water, juices and cookies	5
Filter coffee, espresso, tea, mineral water, juices and Danish pastries (available only from 8am - 1pm)	7
Selection of food	
Themed coffee breaks - savory and sweet	8 - 12,5
Snack and pizza menus	from 5,5
Lunch and dinner (2 /3 / 4 course) set menus	from 12
Lunch Buffet Menus	from 16
Dinner Buffet Menus	from 22
Selection of Canapés 9 / 12 / 15 / 21	15 / 18 / 19,5 / 25
Brunch Menu	24
Live Cooking and Dessert Stations	from 3

All prices mentioned in this document include 20% VAT

HYATT MENUS

Beverage Package	Price per person / €			
	1 Hour	2 Hours	3 Hours	4 Hours
Serving time				
Selection of non-alcoholic beverage	3	5	7	9
Selection of Serbian spirits, beers, house wines <i>Orfelin</i> (Kovačević) and soft drinks	5	7	9	12
Selection of Serbian spirits, beers, <i>Mlad Mesec wines</i> (Do kraja Sveta), soft drinks and juices	7	9	12	18
Selection of Serbian and imported spirits, beers, house wines <i>Orfelin</i> (Kovačević), soft drinks and juices	7	9	12	18
Selection of Serbian imported spirits, beers, <i>Mlad Mesec wines</i> (Do kraja Sveta) soft drinks and juices	9	12	18	21

All prices mentioned in this document include 20% VAT

SELECTION OF SERBIAN SPIRITS

- ◆ Selection of local Rakija
- ◆ Vodka
- ◆ Vermouth
- ◆ Dry Good Gin
- ◆ Beer: Jelen, Lav, Zaječarsko

SELECTION OF IMPORTED SPIRITS

- ◆ Johnny Walker Red, Ballantine's
- ◆ Campari, Martini Bianco
- ◆ Baileys
- ◆ Smirnoff Vodka
- ◆ Beefeater Gin

SELECTION OF NON-ALCOHOLIC DRINKS

- ◆ **NEXT** juices
- ◆ **Soft drinks**
- ◆ **Mineral water**

A/V EQUIPMENT AND ADDITIONAL SERVICES

A/V	Daily price per item / €
Conference sound system for Ballroom with technician	190
Conference sound system for 1/3rd or 2/3rd of ballroom with technician	150
AV Technician (up to 6 hours of engagement)	55
LCD Projector	120
Wireless Microphone	22
Lapel microphone	6
Booth for simultaneous interpretation with technician	100
Tie microphone	30
Projection screen 2m x 2m	25
Projection screen 2.4m x 2.4m	35
Projection screen 3m x 4m	65
Infra-red receiver with headphones (25 – 150)	3
Laptop	50
Plasma screen	130
Flip chart	18
Polycom Conference line	40

All prices mentioned in this document include 20% VAT

HYATT MEETINGS AND EVENTS

Chef's Table

A unique dining concept in Belgrade, prepared and served in the main kitchen area of the Metropolitan Grill restaurant.

A welcome drink will be served on the house at Metropolitan Grill, while additional alcoholic beverages will be charged.

Prices start at €50 per person (for a maximum of 12 persons) including a four-course menu, welcome drink, canapés and Prosecco.

As part of the chef's table offer, our guests can book a cooking class where each guest receives an apron as a gift.

Prices start at €61 per person.



Meeting Planner

Join Hyatt Gold Passport and start enjoying exclusive benefits, room upgrades and free nights with no blackout dates at any Hyatt property worldwide.

As a participant in the Hyatt Gold Passport Planner Rewards programme, you will earn one Hyatt Gold Passport™ bonus point for every US dollar spent on eligible events. You can earn up to 50,000 bonus points per event. Points can be redeemed for free nights, future meeting credits and more. Plus, every qualifying meeting or event helps you to earn credit towards achieving elite tier status in the Hyatt Gold Passport programme, Hyatt's global loyalty scheme.

Every member of the Hyatt Gold Passport programme can gift their points to friends, family or business partners.

Hyatt Catering

Whether it is a gala dinner, corporate reception, incentive party or private event, Hyatt Catering transports your ideas into a world of their own. We offer innovative cuisine and professional service. We can also organise your function at any location of your choice.



Hyatt Regency Belgrade

Milentija Popovića 5, 11070 Belgrade

Tel. +381 11 301 1234

Fax. +381 311 2234

www.belgrade.regency.hyatt.com

www.facebook.com/HyattRegencyBelgrade

All prices mentioned in this document include 20% VAT.

**In case of a change on the Value Added Tax (VAT),
the hotel keeps the right to adjust the prices accordingly with prior written notice.**